



TRANSFER OIL

Pure Fluid Attitude



Female HP | Male CES

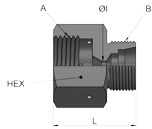

| Part no. | Description | Side A | Side B | ID | HEX | L | MAWP |
|-----------------------|------------------------------|--------|--------|-----|------------|----|------|
| D9GFB 04MK18 01 | 1/4 F-HP M-CES M18 40k 316D | 1/4 | M18 | 2.4 | 7/8 22 | 30 | 40k |
| D9GFB 04MK2 001 | 1/4 F-HP M-CES M20 40k 316D | 1/4 | M20 | 2.4 | 7/8 22 | 30 | 40k |
| D9GFB 04MK22 01 | 1/4 F-HP M-CES M22 40k 316D | 1/4 | M22 | 2.4 | 1 26 | 32 | 40k |
| D9NFB 04MK2 401 | 1/4 F-HP M-CES M24 45k 316D | 1/4 | M24 | 2.4 | 1 26 | 32 | 45k |
| D9GFB 06MK18 01 | 3/8 F-HP M-CES M18 40k 316D | 3/8 | M18 | 3.2 | 1 26 | 33 | 40k |
| D9GFB 06MK20 01 | 3/8 F-HP M-CES M20 40k 316D | 3/8 | M20 | 3.2 | 1 26 | 33 | 40k |
| D9GFB 06MK22 01 | 3/8 F-HP M-CES M22 40k 316D | 3/8 | M22 | 3.2 | 1 26 | 35 | 40k |
| D9NFB 06MK24 01 | 3/8 F-HP M-CES M24 45k 316D | 3/8 | M24 | 3.2 | 1 26 | 35 | 45k |
| D9FFB0 6MK300 1 | 3/8 F-HP M-CES M30 30k 316D | 3/8 | M30 | 3.2 | 1+3/8 35 | 37 | 30k |
| D9GFB 09MK18 01 | 9/16 F-HP M-CES M18 40k 316D | 9/16 | M18 | 4.8 | 1+3/8 35 | 38 | 40k |
| D9GFB 09MK20 01 | 9/16 F-HP M-CES M20 40k 316D | 9/16 | M20 | 4.8 | 1+3/8 35 | 38 | 40k |
| D9GFB 09MK22 01 | 9/16 F-HP M-CES M22 40k 316D | 9/16 | M22 | 4.8 | 1+3/8 35 | 40 | 40k |
| D9NFB 09MK24 01 | 9/16 F-HP M-CES M24 45k 316D | 9/16 | M24 | 4.8 | 1+3/8 35 | 40 | 45k |
| D9FFB0 9MK300 1 | 9/16 F-HP M-CES M30 30k 316D | 9/16 | M30 | 4.8 | 1+3/8 35 | 42 | 30k |
| D9MFB 09MK36 01 | 9/16 F-HP M-CES M36 24k 316D | 9/16 | M36 | 4.8 | 1+1/2 38 | 44 | 24k |
| D9DFB 09MK42 01 | 9/16 F-HP M-CES M42 15k 316D | 9/16 | M42 | 4.8 | 1+3/4 45 | 46 | 15k |

*I valori e le dimensioni mostrate possono essere modificati senza preavviso per migliorare le prestazioni e l'affidabilità del prodotto.
Transfer Oil S.p.A. non si assume alcuna responsabilità per imprecisioni o errori che appaiono in questa scheda tecnica.
Data documento: 01/04/2025
www.transferoil.com*